

# Oasis 48-inch Shower Compartment With ActivLife Single-Bar (1-Horizontal) Package

48-inch / Private Access / Bars Only



**Specification** – Oasis one-piece FRP gelcoat shower compartment SH-4836, offered in a standard 4-inch or 6-inch (ABF) dam configuration. ActivLife package includes a single horizontal bar on the back wall.

**Standards Certification:**

The shower compartment listed is manufactured in compliance with ANSI Z124 Standards, and certified through an ongoing, independent quality assurance and testing program.

The factory-applied grab bar package is certified through an independent review program.



**SH-4836 / BP5**  
(single-bar package)  
Model & Package Illustrated

**NOTE:** Positioning of factory attached grab bars allow for installation of a shower enclosure.



**Home Innovation**  
LAB CERTIFIED™



	Std Unit	ABF Unit
A	76-3/4"	78-3/4"
B	75-1/2"	77-1/2"
C	4"	6"
D	1"	3"
E	-	-
F	-	-

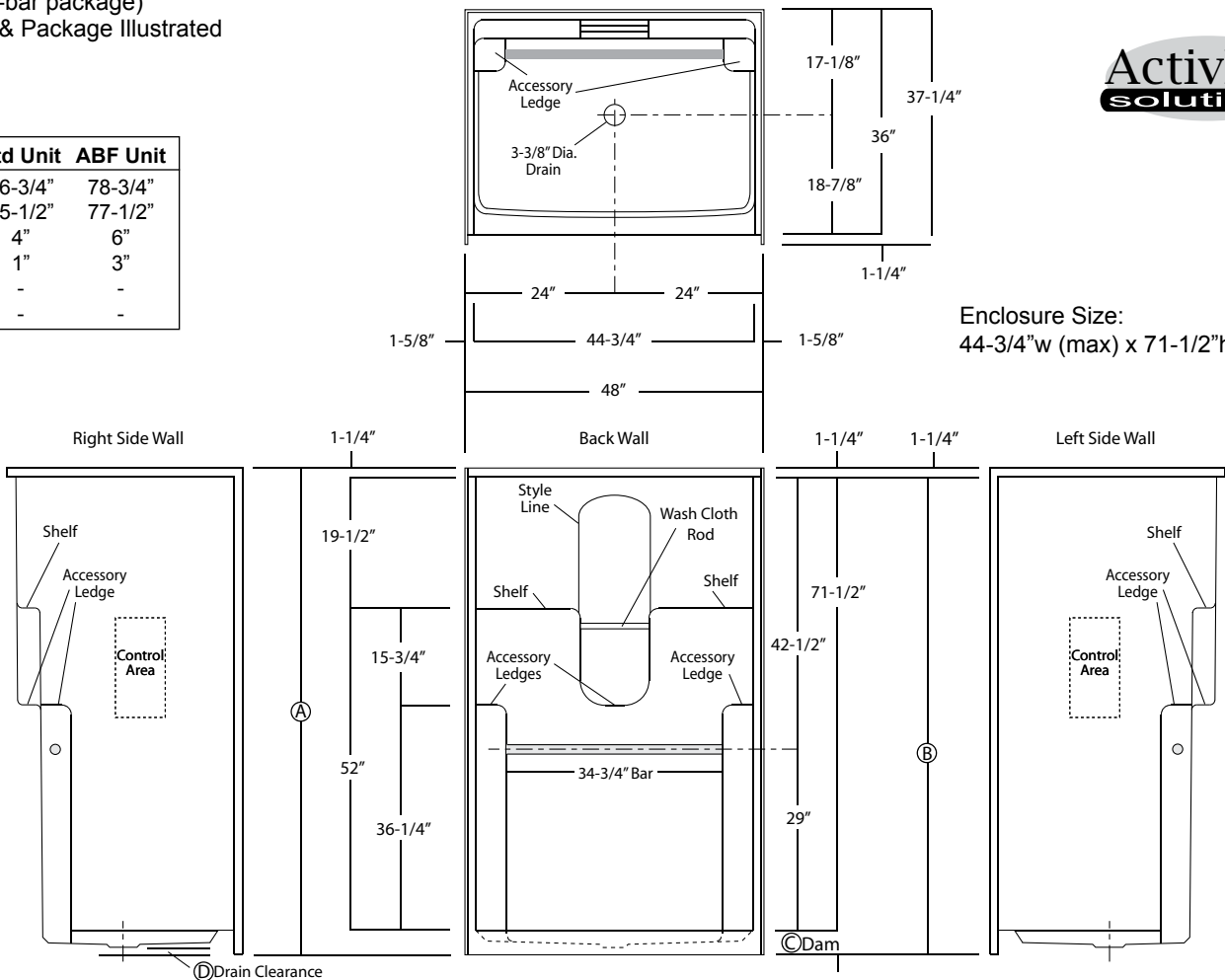

Enclosure Size:  
44-3/4" w (max) x 71-1/2" h (max)

Dimensions shown are maximum. Due to the nature of the materials involved, actual unit dimensions can vary (tolerances: +0 / -3/8 inch). Oasis reserves the right to modify or discontinue product and/or associated equipment without prior written or verbal notification or obligation.

Model ID	Package Code	Description
SH-4836 (Std or ABF)	/ BP5	48" x 36", center drain shower with 4" (std) or 6" (ABF) dam, and ActivLife 1.50" dia. stainless steel single bar package (single horizontal back wall bar).
<b>Powder Coated Bar Packages (1.25-inch dia.)</b>		
SH-4836 (Std or ABF)	/ BP5 WHT	48" x 36", center drain shower with 4" (std) or 6" (ABF) dam, and ActivLife 1.25" dia. white powder coated single bar package (single horizontal back wall bar).
SH-4836 (Std or ABF)	/ BP5 OFW	48" x 36", center drain shower with 4" (std) or 6" (ABF) dam, and ActivLife 1.25" dia. off-white powder coated single bar package (single horizontal back wall bar).
SH-4836 (Std or ABF)	/ BP5 SNK	48" x 36", center drain shower with 4" (std) or 6" (ABF) dam, and ActivLife 1.25" dia. nickel finish single bar package (single horizontal back wall bar).

**Package Notes:**

1. Model available without listed package.
2. For bar and seat packages, see ActivLife "TL-RS/LS" and "TLV-RS/LS" package codes.
3. For 3-bar package with a vertical bar on control wall, see ActivLife "BP2" package code.
4. For 2-bar package without a vertical bar on control wall, see ActivLife "BP1" package code.
5. For 3-wall horizontal bar package, see ActivLife "BP3" package code.
6. For REINFORCEMENT ONLY for horizontal bars (HUD/FHA-Fair Housing), see ActivLife "FH" package code.
7. For expanded reinforcement package options, (with or without listed package components), see ActivLife "3SM" and "3SF" package codes.

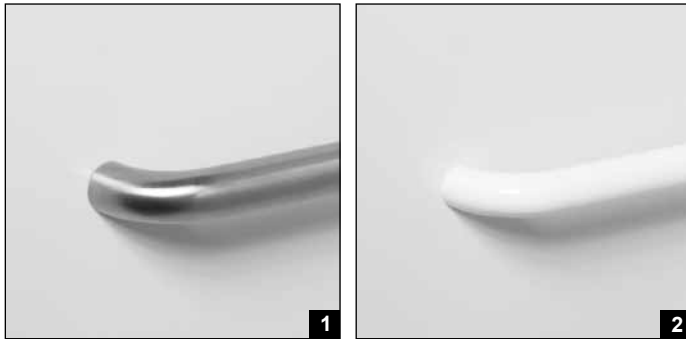
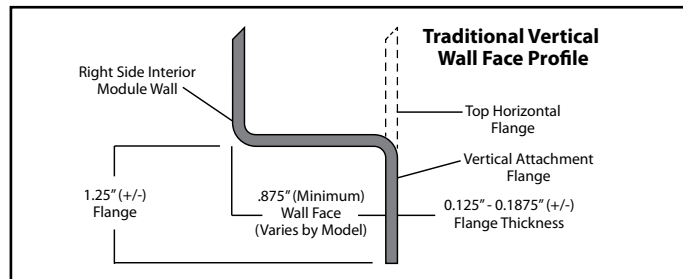

Photo 1: Grab Bars: Factory-installed 1.50-inch diameter, concealed attachment, 18 gauge, #304 brushed stainless steel grab bars. Concealed attachment design provides tamper-resistance and minimizes debris collection areas at contact points, compared to common exposed flange bar designs, without compromising bar attachment integrity. (Reinforced areas include a structural core material encapsulated in FRP composite.)

Photo 2: Grab Bars: Factory-installed 1.25-inch dia. powder coated (in finishes listed above), concealed attachment, 18 gauge, #304 stainless steel grab bars. Concealed attachment design provides tamper-resistance and minimizes debris collection areas at contact points, compared to common exposed flange bar designs, without compromising bar attachment integrity. (Reinforced areas include a structural core material encapsulated in FRP composite.)